

BRP-Rotax ILLUSTRATED PARTS CATALOG

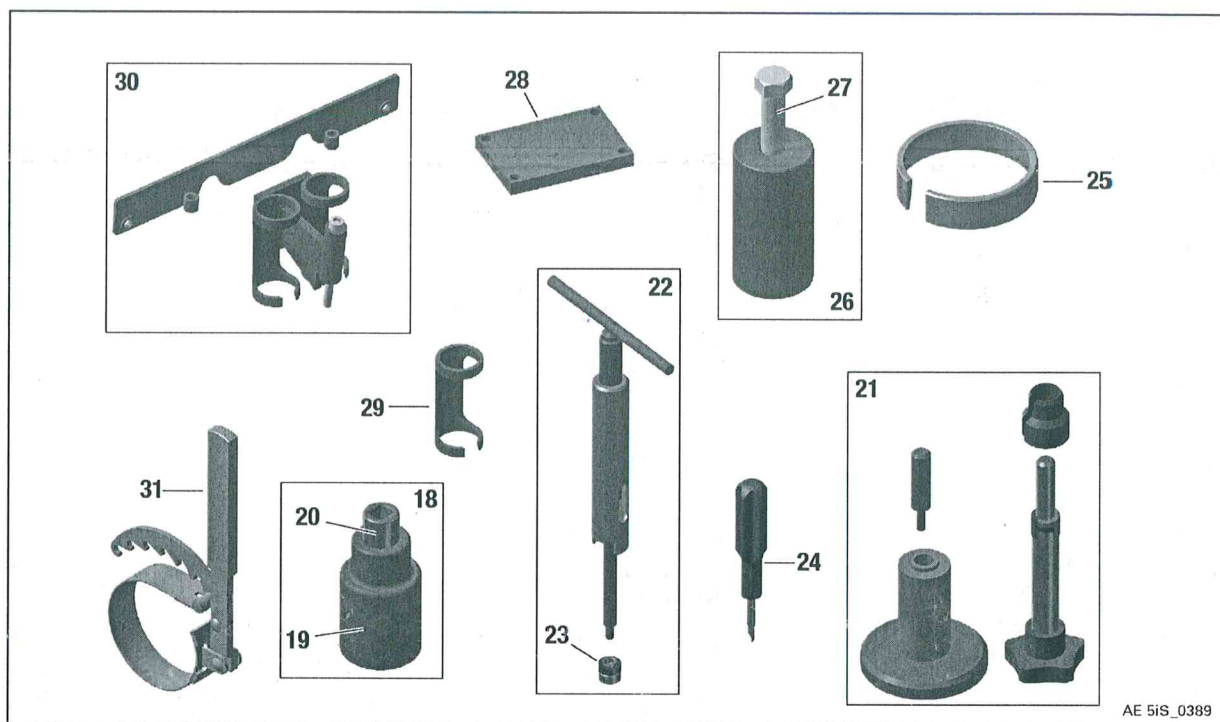

Figure 1.5: Repair tools

| ITEM NO. | APPLICATION | ITEM NO. | APPLICATION |
|----------|-----------------------------------|----------|--------------------------------------|
| 18-20 | Drive gear, gearbox, gear set | 26-27 | Puller magneto hub |
| 21 | Fitting of piston pin circlips | 28 | To align cylinders |
| 22-23 | Fitting and removal of piston pin | 29-30 | Installation/Removal of valve spring |
| 24 | Monohook clips puller | 31 | Oil filter removal |
| 25 | Piston diameter 84 mm / 33 in. | | |